

SHOPPERS CITY EAST

DESCRIPTION

This one-storey centre is located at Ogilvie Road and Blair Road, two of the main arteries in the east end known as Gloucester. Within a 5 - 10 km radius surrounding this centre is a densely populated residential area. Directly adjacent to the centre is a 4 building, 414,000 s.f. office complex

which also feeds the centre. The property is located in close proximity to Gloucester Centre and Gloucester Silver City Centre with such retailers as Chapters, Old Navy, Future Shop and Famous Players-Silver City.

OPENING DATE: 1962

LEASING

20 VIC MANAGEMENT INC.
1 Queen Street East
Suite 300, Box #88
Toronto, Ontario
M5C 2W5

Tel: (416) 955-0595
Fax: (416) 955-0569

CENTRE ADDRESS

2012 - 2036 Ogilvie Road
Ottawa, Ontario
K1J 7N9

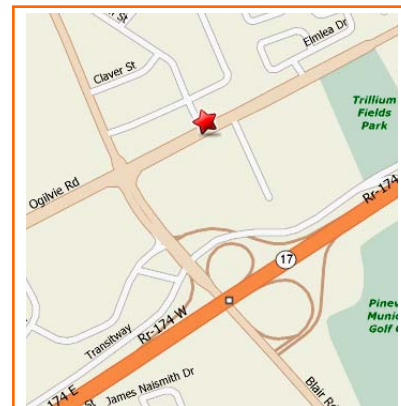
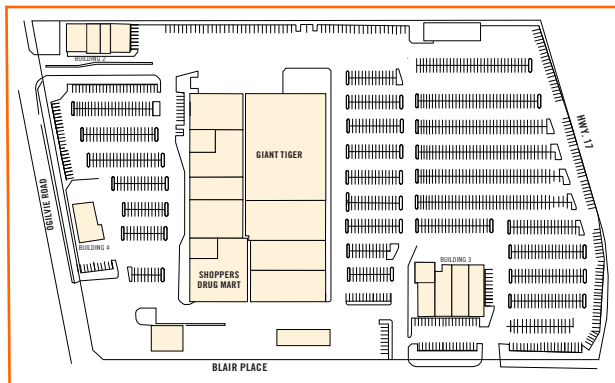

SHOPPERS CITY EAST

SIZE, AMENITIES

G.L.A.:	160,915 sq ft	MAJOR RETAILERS:	
RETAIL STORES:	20	Giant Tiger	35,000 sq ft
PARKING SPACES:	800	Staples	
		Business Depot	21,343 sq ft
		Shoppers Drug Mart	15,000 sq ft

TENANTS

The Barber Shop	The Liquor Store
The Beer Store	Pet Valu
Wells Salvation Church	Pioneer Petroleum
Burger King	Quickie Convenience
Diet Centre	Rogers Video
Dollarama	Santo Busa Shoe Repair
Dominion Outreach Centre	Shoppers Drug Mart
Fabricland	Staples
Gabriel's Pizza	Weekly Flowers
Giant Tiger	
Gloucester Family Dental	

MARKET

Trade Area Population:	
Primary	88,000
Secondary	154,000
Average Household Income:	\$58,800
Vehicle Traffic Count:	57,000 per day

CONTACTS

Leasing:

Abie Grunspan (514) 798-2050 Fax: (514) 798-2060
email: agrunspan@20vic.com

Property Manager:

Lucie Duguay (613) 725-1551 Fax: (613) 725-9201

Business Unit:

John Pretsell, Vice President (416) 681-9006 Fax: (416) 955-0569

<http://www.20vic.com>

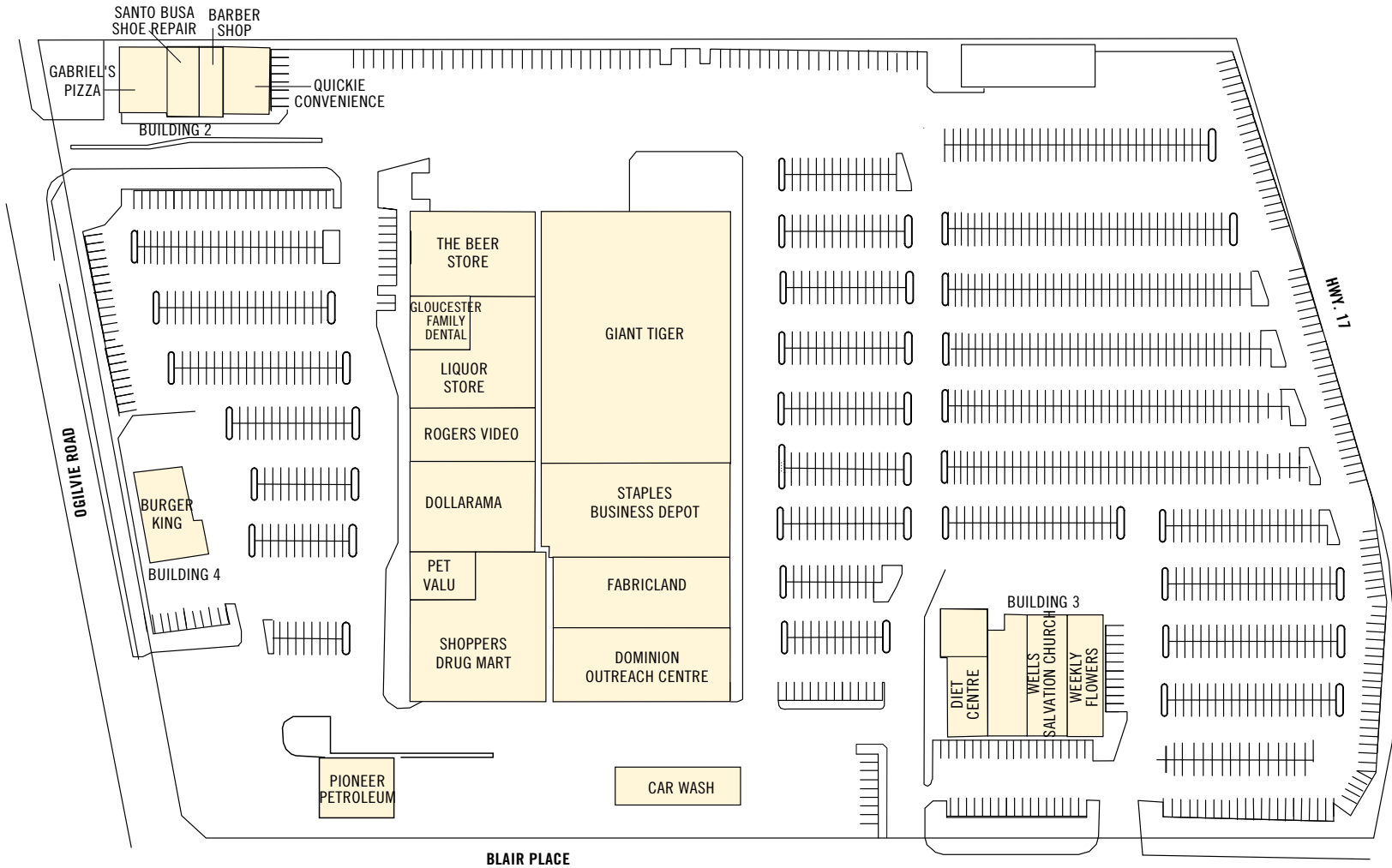

SHOPPER'S CITY EAST